

# TALzine

2016 • 03



# DALSGAARD

## INTRODUCTION

With the DALSGAARD wood collection, a tribute to the Danish football player Henrik Dalsgaard, lighting manufacturer TAL takes its inspiration directly from nature. DALSGAARD is a natural ensemble, born from the bark of a solid oak tree. The light fixtures reflect the organic shapes of nature, and the wood, with its fascinating grain, seems to embrace the light. That same light, in turn, brings the wood to life. DALSGAARD is a truly warm collection that stimulates all of the senses. The collection's absolute highlight is no doubt VIENNA, a bare chandelier based on the original design of Austrian architect Adolf Loos. By using wood, TAL has elevated this stately chandelier to a higher level. VIENNA is a real eye-catching piece with a classic design.

The series also includes a number of light fixtures that can be both suspended from the ceiling and ceiling or wall-mounted. All lighting fixtures share the same round, natural shape and state-of-the-art technical specs. FABIAN, for instance, is equipped with LED technology and a matte diffuser that ensures that the light is distributed evenly and beautifully without compromising on efficiency. JAMES is a beautiful, organically shaped fixture, equipped with an elegant, cymbal-shaped reflector. The reflector is available in textured white, copper and brass. The latter finishing is new to TAL and proves to be very effective in combination with the warm wood. The light of the integrated LED module simply glides over the reflector, which results in an unsurpassed interplay of natural materials.

In short, TAL's wood collection presents the true beauty of nature in a bright light. DALSGAARD is made in Belgium with an absolutely beautiful Scandinavian touch.

# INDEX

- P02 **INTRODUCTION** | DALSGAARD
- P04 **NEW PRODUCT** | JAMES OAK
- P05 **DALSGAARD LAUNCH** | XPERIENCE HOME ANTWERP
- P07 **PRODUCT EXPANSION** | ROBAN OAK
- P08 **PROJECT** | 411 (COMMA MERKENMARKETEERS)
- P10 **NEW PRODUCT** | KALEBAS
- P11 **PRODUCT UPDATE** | FABIAN OAK
- P12 **NEW PRODUCT** | TIMBER
- P13 **DALSGAARD EVENT** | SV ZULTE WAREGEM
- P15 **DID YOU KNOW THAT...** | DALSGAARD
- P16 **MAKING OF** | PHOTOSHOOT DALSGAARD CAMPAIGN
- P17 **TAL CLASSIC** | VIENNA

# NEW PRODUCT | JAMES OAK

The JAMES is a wonderful new piece that can be used both as general light source and for mood lighting. As such, JAMES can be installed directly on the wall or the ceiling, and hung from the ceiling as pendulum lighting as well. JAMES consists of a rounded wooden sheath with an elegant cymbal-shaped reflector nestled within. This reflector comes in white for a nicely even light distribution, but also in brass and copper. The metal versions provide an extra warm glow.

**Design by: David Sprengers**

FINISH	NOT DIMMABLE		MAINS DIMMABLE	
	2700K	3000K	2700K	3000K
OAK + BRASS	481215	481225	481315	481325
OAK + TEXTURED WHITE	481247	481257	481347	481357
OAK + COPPER	481250	481260	481350	481360

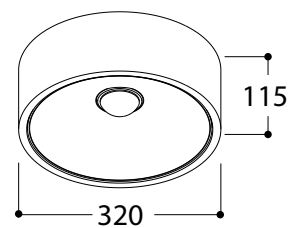
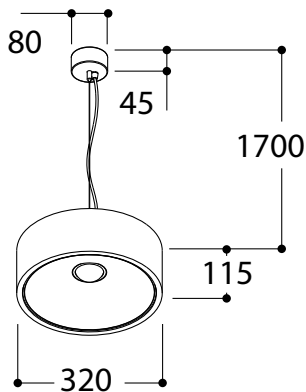

# DALSGAARD LAUNCH | EXPERIENCE HOME (ANTWERP)



[www.antwerpexperiencehome.be](http://www.antwerpexperiencehome.be)



# DALSGAARD LAUNCH | EXPERIENCE HOME (ANTWERP)



# PRODUCT EXPANSION | ROBAN OAK

The ROBAN, named a true TAL classic in a previous TALzine, has now also been given a beautiful oaken casing. The oak adds an extra warm touch to any interior.

The reflector is available in 3 finishes; textured white, brass and copper.

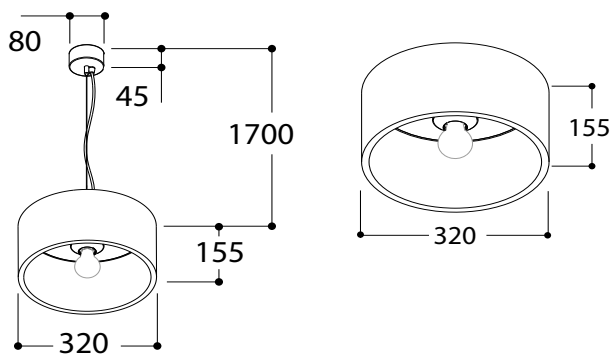

## ROBAN SURFACE

FINISH	E27	CARET
OAK + BRASS	481615	481625
OAK + TEXTURED WHITE	481647	481657
OAK + COPPER	481650	481660

## ROBAN SUSPENDED

FINISH	E27	CARET
OAK + BRASS	481715	481725
OAK + TEXTURED WHITE	481747	481757
OAK + COPPER	481750	481760



# PROJECT | 4 1 1 (COMMA MERKENMARKETEERS)



411sessions.be  
www.merkenmarketeers.be





# PROJECT | 4 1 1 (COMMA MERKENMARKETEERS)

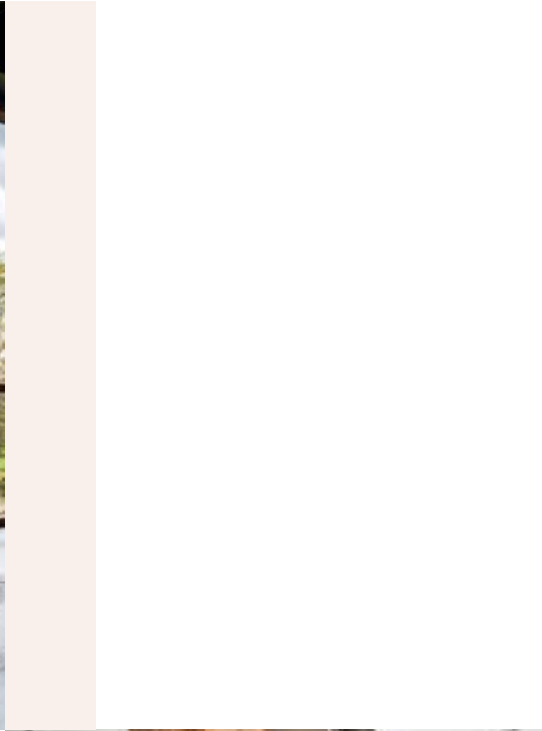

## NEW PRODUCT | KALEBAS

The Kalebas is gourd-shaped, as the Dutch name Kalebas suggests. The gourd also features in the DALSGAARD collection, with the back end consisting of twisted oak and the actual lamp casing made of aluminium with a lacquered white/black, brass or copper finish.

The gourd is the perfect vehicle for led lights with an E27 base, because only the luminous part will be visible, and the technical parts will be hidden away in the gourd nicely.

**Design: Lieven Musschoot & Cas Moor**





## PRODUCT UPDATE | FABIAN OAK

Just like the ROBAN, the FABIAN has also been given a new oak finish. The FABIAN OAK is great for general lighting, because the light fixture in itself serves almost as a decorative item. Moreover, the FABIAN OAK comes equipped with the latest in LED technology, and is therefore super efficient!

FABIAN	Mains dimmable	Dali/Touch dimmable
Surface Mounted	481000	481050
Suspended	481100	481150



## NEW PRODUCT | TIMBER

The TIMBER is a beautiful beam-shaped addition to our collection. TIMBER is equipped with the latest in LED technology and as such, makes for excellent workplace lighting, kitchen lighting, etc.

In short, TIMBER is suited for any situation where a lot of light is required, from a light fixture that also looks stunning. TIMBER comes with an oak finish and is also equipped with a highly efficient diffuser in frosted polycarbonate.



# DALSGAARD EVENT | SV ZULTE WAREGEM



# DALSGAARD EVENT | SV ZULTE WAREGEM



## DID YOU KNOW...

The wood used for the DALSGAARD collection is all 100% Belgian oak?

Moreover, all of the wood is FSC-certified, the primary quality label for responsible forest management, meaning that no trees are cut down needlessly for our DALSGAARD collection.



FSC-STD-40-004 V2-1 Standard for COC Certification - october 2011

FSC-STD-40-005 V2-1 Standard for Company Evaluation of FSC Controlled Wood - April 2007

FSC-STD-40-003 V2-1 Standard for Multi-site Certification of Chain of Custody Operations

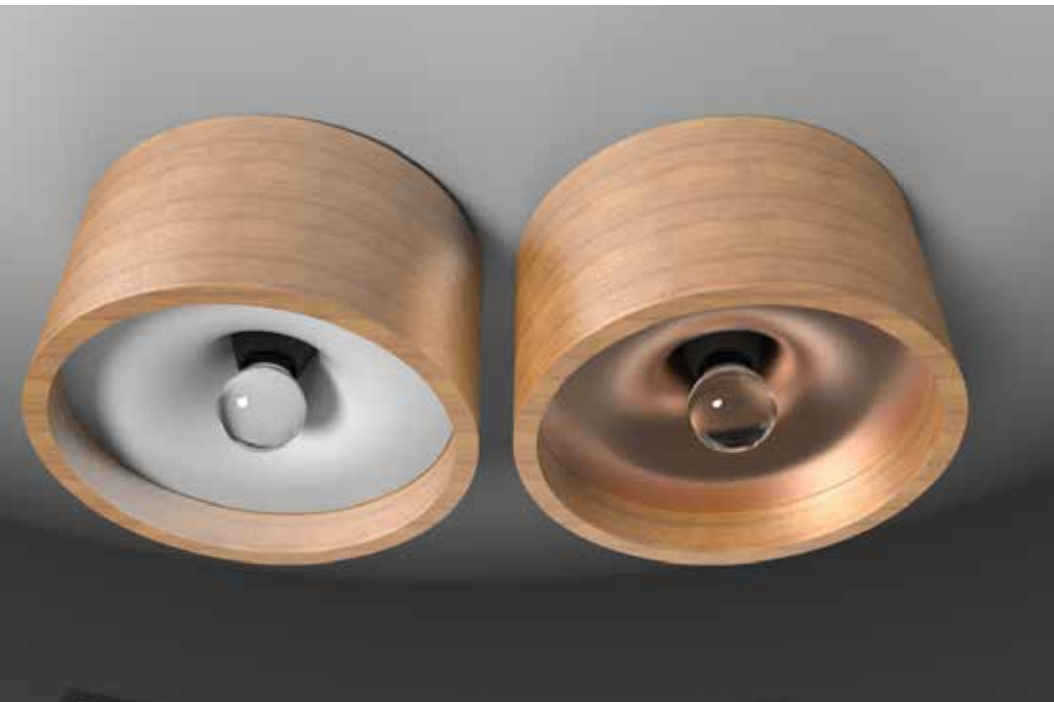

# MAKING OF | PHOTOSHOOT DALSGAARD CAMPAIGN





# TAL CLASSIC (TO BE) | VIENNA

This classic requires a bit of time travel; it was designed by architect Adolf Loos a century ago. We modernized and minimized this classic for the modern world. This distilled design consists of Belgian oak and was given the name 'Vienna' as a tribute to Adolf Loos, who spent a large portion of his life in the Austrian city of Vienna.

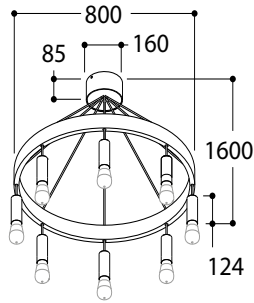



Joos de ter Beerslaan 33  
8740 Pittem  
Belgium

T +32 (0)51 46 43 41  
F +32 (0)51 46 43 42

info@tal.be  
www.tal.be

**TAL**  
TECHNICAL  
ARCHITECTURAL  
LIGHTING